

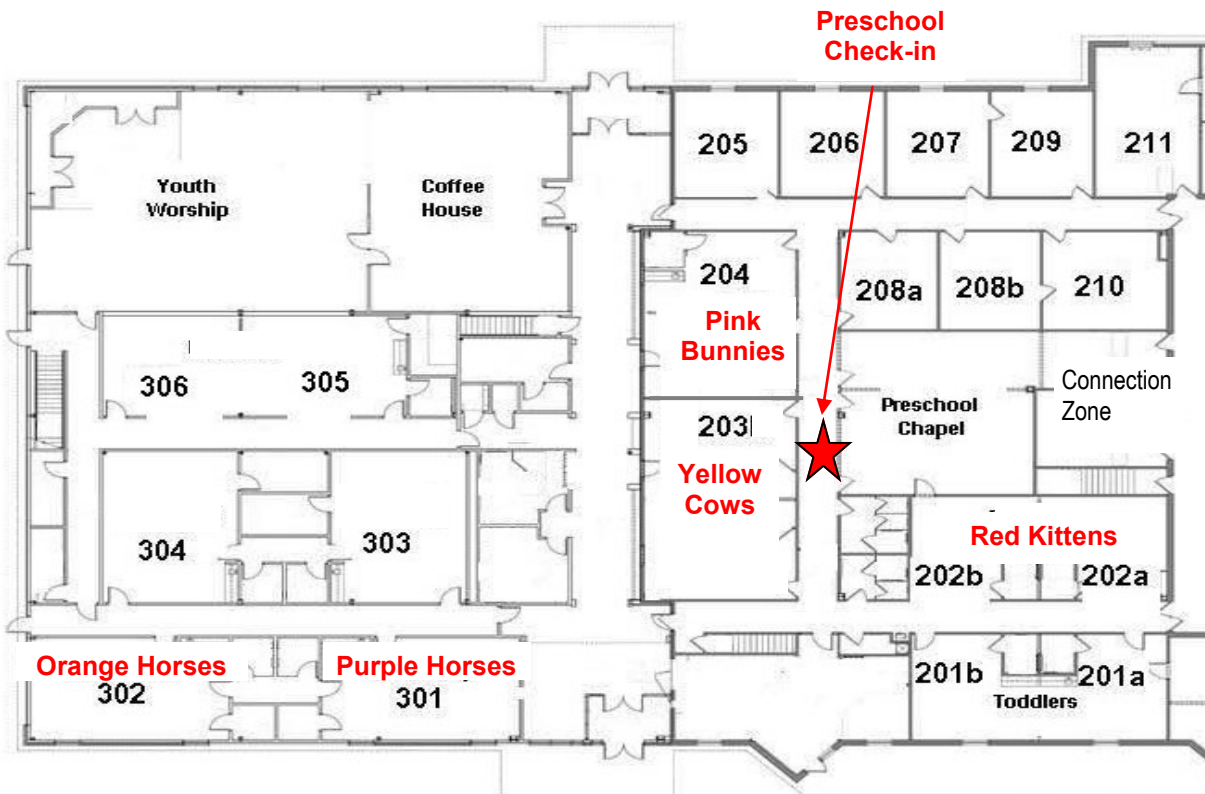





First Church of God Preschool Classroom Locations



kidsconnection

Gymnasium



Groups	Ages	Location
	Orange Horses were born between August 2006 and February 2007.	Room 302
	Purple Horses were born between March 2007 and June 2007.	Room 301
	Pink Bunnies were born between July 2007 and May 2008.	Room 204
	Yellow cows were born between June 2008 and October 2008	Room 203
	Red Kittens were born between November 2008 and March 2009	Room 202

Preschool Kids Connection

Preschool Check-in

The check-in table will be located outside the children's chapel prior to both service hours. Please place your child's nametag on your child and sign your child in completely every week by listing who brought the child, your location during each of the hours, and any other information we might need for that day.

If you arrive late and the greeter is gone, we still need you to sign in and tag your child. This information is used for attendance purposes and would be our reference list in an emergency.

What to Bring to Church

If your child is still in diapers or is still in the shaky stages of potty training, please send a bag with diapering supplies and/or a change of clothes. If you need a bag tag for your child's bag, please ask the greeter at the check in table. Please place bags in your child's classroom, not in the children's chapel.

Please do not send your child to church with toys or items from home. With approximately 45 preschool children it is difficult to keep track of these items and it can be hard for your child to share things of his or her own. We do our best to keep track of sweaters, shoes, hair accessories, etc. If your child misplaces a clothing item while at church, please check the lost and found outside the main nursery area. If you allow your older preschooler to bring a Bible, please put his or her name in it.

There is no need to bring food or drink for your child. We serve light snacks to keep rumbly tummies away and offer water to quench thirst. If your child has special dietary needs, please contact Mindy Hoffman or see the greeter at check-in.

Sunday Morning Schedule

Year 1 — Cows and Kittens

8:45	Greeters in Chapel
9:00- 9:10	Music in Chapel
9:10- 9:15	Transition to classroom
9:15- 9:50	Story and activities
9:50-10:00	Diapers and bathroom
10:00-10:30	Free play in classroom
*10:15	Volunteers switch
10:35-10:55	Gym time
10:55-11:10	Snack
11:10-11:30	Diapers &bathroom, free play in room

Year 2 & 3 — Horses and Bunnies

8:45	Greeters in Chapel
9:00- 9:10	Music in Chapel
9:10- 9:15	Transition to classroom
9:15-10:00	Lesson and bathroom break
10:00-10:05	Transition to Chapel
10:05-10:30	Video curriculum
*10:15	Volunteers switch
10:30-11:00	Lesson and snack
11:00-11:20	Gym time
11:20-11:30	Return to classroom for pick-up

If you have questions or concerns, please contact Mindy Hoffman at 244-5959 or mindy@firstchurchconnect.com



kidsconnection